



日暁



Happy Easter!

Congratulations on Your Entrance to Our School for the New Students!

Congratulations on your entrance to all new students. We are very glad to welcome you. From today on, you will spend your school days with your new friends and with a lot of hope in the wilderness of Gyosei International Primary School campus. You will study here every day with the help of your teachers and staff. You will get your mind educated. Both your mind and body will grow each day. You will do your best to get closer to God. You will not waste even a day to grow as an asset for your parents. You will do your best to lay the base for living on this earth and ultimately to become an honorable man as the light of the world. You will thank your parents for raising you up today. You will be friendly with your new friends whom you will meet here for the first time. You will do your best to enable everyone to study peacefully and happily and grow well as a child of God. Many cherry trees have been planted on our school campus. They have grown significantly and their beautiful blossoms are welcoming you. Again, do your best to be the light of the world while thanking all the people you will meet.

D. Tagawa S.M.

Verse for April

“You are the salt of the earth. — You are the light of the world.”

«Vous êtes le sel de la terre. — Vous êtes la lumière du monde.»

—Matthew 5:13-16—

April Chant:

“Mary’s Heart”

Motto for April:

Let’s greet each other with a smile.

Let’s uphold the school regulations and live properly.

Safety Reminder for April

Let’s follow the traffic rules.



◆ Regular Classes from Monday

Students from grade 2 and above, please be sure to bring your lesson bags to put subject files inside. Hang them on the right side of your desks. Please also bring your locker boxes and desk drawers. Also remember your lunch sets as we will have regular lunch.

◆ 2023 Primary School Faculty and Staff

• Principal:	Vice-Principal:
• 1A:	• 1B:
• 2A:	• 2B:
• 3A:	• 3B:
• 4A:	• 4B:
• 5A:	• 5B:
• 6A:	• 6B:
• Japanese for B class:	• English (1A – 4A) :
• Science:	• English (5A – 6A) :
• P.E.:	• French (1-3-6) :
• Music:	• French (2-4-5) :
• Computer Studies:	• School Nurse:
• Home Economics:	
• Religious Studies:	• Secretary:
• Religions Studies:	• Secretary:

◆ 2023 Primary School Building Classroom Layout

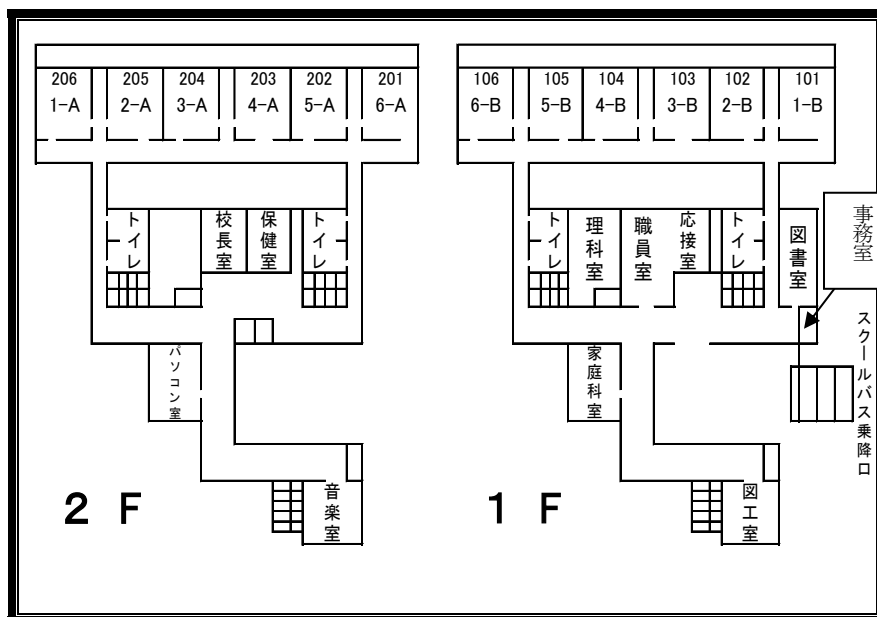

* When you visit us, please be sure to write your name in the notebook at the reception.

* The back entrance on the parking side is for our staff only.

* The entry of vehicles into the roundabout is prohibited.

◆ School Term Calendar and April Schedule

The annual school term calendar schedule was distributed this day for new students as follows: First term – April 8th (Saturday) until July 22nd (Saturday), Second term – September 1st (Friday) until December 16th (Saturday), Third term – January 6th (Saturday) until March 16th (Saturday).

There will be changes in class dismissal occasionally due to some school events such as parents class observation, parents and teacher meetings, and closing ceremony. An official notice from school thru Aktsuki newsletter, and automatic messaging system will be activated.

On April 19th (Wednesday) the school spring field trip will take place and it will be clam digging. The first class observation and parents meeting will take place on April 29th (Saturday). An official school letter with details will be distributed later.

◆ **Schedule of Certification Tests**

It is recommended that students should take the English Proficiency Test and Kanji Proficiency Test at least once a school year. The other certification tests are open to anyone who wishes to take them regardless of grade level. The tests will be held during regular class periods, and the students who are not taking the test will have regular lessons. Letters of application will be distributed later so please make sure to submit the application slip to the homeroom teacher until the deadline.

Eiken English Test	May 27 th Sat.	October 6 th Fri.	January 13 th Sat.
Kanji Certification Test	June 9 th Fri.	January 20 th Sat.	
Math Certification Test	January 27 th Sat.		
Japanese Certification Test	November 11 th Sat.		

The French proficiency test is scheduled on November 19 (Sunday), please be aware that the school can hold it upon reaching the required number of applicants. A notice letter with details of application period will be distributed later.

◆ **Notice of Absence and Tardy Report services**

Starting on Monday – April 10th, our school will make use of the services of Mimamorume’s application or email messaging system to report an absence and late arrival. Please read the setting information and ID card distributed today and register. Please make sure to notify the school bus driver as well for being absent. For students using the Kawasaki school bus service, instead of calling the driver, please call the office of the bus company. Students using Kisarazu school bus are not required to notify it. You will find the contact details in the letter distributed today.

◆ **Mail Services**

This school year, we will use two companies, NTT and Mimamorume, to provide simultaneous messaging services. For the time being, NTT general mail service will be in use, so kindly read the details from the letter distributed today and register. Concerning Mimamorume’s simultaneous messaging services, we will let you know the details later as soon as we are ready to use it, so please do not inquire or contact the company directly for the meantime.

◆ **About Mimamorume GPS**

Details of Mimamorume’s GPS subscription will be distributed at a later date. Using the services is voluntary, but we hope you will join it to be doubly careful of the children’s safety.

◆ **Travel To and From School**

Boarding and getting off transportation:

- Except for major delays in public transportation, the school bus departs on time. Please be sure to go to school on time.
- Please be sure to confirm with your child how he or she will be going to and returning from school, as a sudden change of schedule or way of picking up can cause confusion and could jeopardize safety.

Behavior while riding the school bus and other transportation:

- For safety driving of the driver, always be quiet.
- Always observe proper behavior while waiting on the platform and riding the train to avoid annoying other passengers. Moving or transferring to another train car is not allowed not unless it is an emergency.
- Students are allowed to read books that promote positive education. Parents who are concerned about students getting motion sickness or have concerns about eyesight, please decide on a policy at home. Please do not allow them to lend or borrow books on the bus and train.
- The following items like origami, free notebooks, and writing skills drills that can lead to garbage on the bus, should not be used.
- The same rules applicable to the classroom are in effect on the bus as well. Food and drink are not permitted, and we ask that food should not be brought from home.

Others:

- Parents are not permitted to ride the bus.
- Travel guidance meetings are scheduled for the beginning of each term and teachers will be instructing students regarding the above mentioned rules and manners.
- If you drop off and pick up your children by car at designated bus stops, please be sure to keep proper manners. Please avoid stopping at no stopping zones on the side of the road or using store's parking lots.
- Commuting by bicycle is forbidden for safety reasons.
- Grade 1 students are to wear traffic safety badges on their left arm until about the middle of June. The badges will be distributed in the classroom on the first day of school.
- For those of you who pick up and drop off your children at the school, please use the designated parking lot and be sure that your children walk across the cross walk.
- We would like you to tell your child not to play in and around the parking lot for safety while he or she is waiting for you in the parking lot.
- Please refrain from long conversations with other parents in the parking lot.
- If you are concerned about any points regarding manners or safety, please contact your child's homeroom teacher.

◆ **Notification of Kids Mobile Phone**

Please submit a notification of possession of the kid's mobile phone to the school through the homeroom teacher. Kindly include and register the school phone number (0438-52-3851) in the list. Students from grade 2 and above must resubmit the notification in April every year.

◆ **Textbooks**

Students will receive new textbooks today and the payment will be deducted soon, so please make sure that there is enough fund. For new students, kindly deposit an additional amount of ¥30,000 yen with the previous ¥230,000 yen amount for student's miscellaneous expenses due to price increase. Please make the bank transfer to the following account.

◆ **Maria Boutique**

As the new school year begins, we ask that you should place your orders as soon as possible for any items you desire without writing the amount.

Please be aware of the following matters when purchasing school supplies from the boutique.

- Do not forget to write the item name, size, quantity when purchasing using the slip. Please also fill male or female, short sleeves, long sleeves and others.
- Parents can purchase items in the boutique directly, using cash. The boutique does not accept credit cards or electronic money.
- When you wish to return items to change the size, please do it within one week of purchase and return with tags, bags, boxes etc. as they are new. Please understand that some items cannot be changed depending on the situation.

If you have any questions, please contact Maria Boutique:

TEL: 0438-52-2510 FAX: 0438-52-3846 E-mail: boutique@gis.ac.jp

◆ **Tuition fee and Student Account**

Please separate bank transfer payments for tuition fee and student account.

Tuition: 3072188 (Savings), Chiba Bank, Kisarazu Branch

Student Account: 1100029 (Savings), Chiba Bank, Kisarazu Branch or 0279121 (Savings),

Mitsubishi UFJ Bank, Kisarazu Branch.

