



晓

Happy Easter!

### Congratulations on Your Entrance to Our School for the New Students!

Congratulations on your entrance to all new students. We are very glad to welcome you. From today on, you will spend your school days with your new friends and with a lot of hope in the wilderness of Gyosei International Primary School campus. You will study here every day with the help of your teachers and staff. You will get your mind educated. Both your mind and body will grow each day. You will do your best to get closer to God. You will not waste even a day to grow as an asset for your parents. You will do your best to lay the base for living on this earth and ultimately to become an honorable man as the light of the world. You will thank your parents for raising you up today. You will be friendly with your new friends whom you will meet here for the first time. You will do your best to enable everyone to study peacefully and happily and grow well as a child of God.

Many cherry trees have been planted on our school campus. They have grown significantly and their beautiful blossoms are welcoming you. Again, do your best to be the light of the world while thanking all the people you will meet.

*D. Tagawa S.M.*

#### Verse for April

“You are the salt of the earth. — You are the light of the world.”

«Vous êtes le sel de la terre. — Vous êtes la lumière du monde.»

-Matthew 5:13-16-

#### Hymn for April

“The Heart of Mother Mary”

#### Motto for April:

Let's greet each other with a smile.

Let's uphold the school regulations and live properly.

#### Safety Reminder for April

Let's follow the traffic rules.

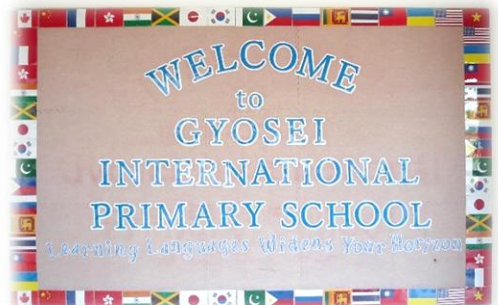

#### Message from Principal

This spring, as we welcome a new academic year, I am truly delighted to once again walk together with all of you as the principal of our elementary school.

Our school places great importance on education grounded in the spirit of Christianity. The founding philosophy established by Fr. Shigeru Tagawa continues to serve as our guiding light across the years. All of our faculty and staff carry this spirit in their hearts as we devote ourselves daily to nurturing the growth of each and every child.

At the start of this new school year, I hope that each of you will take a step forward toward your goals and dreams with courage and determination. Things may not always go as planned. However, by continuing to make an effort, I am certain that you will discover something truly meaningful. It is through this journey that you will come to find the mission given to you by God.

The Bible says, “Ask, and it will be given to you; seek, and you will find” (Matthew 7:7). As we pursue love, justice, and truth, and under the spirit of “Plus Haut!” (“Higher!”) upheld by Fr. Tagawa, we too will continue to grow together with our children.

Thank you for your continued support and cooperation in the coming year.

Tadashi Miura  
Principal

◆ **2026 Primary School Building Classroom Layout**

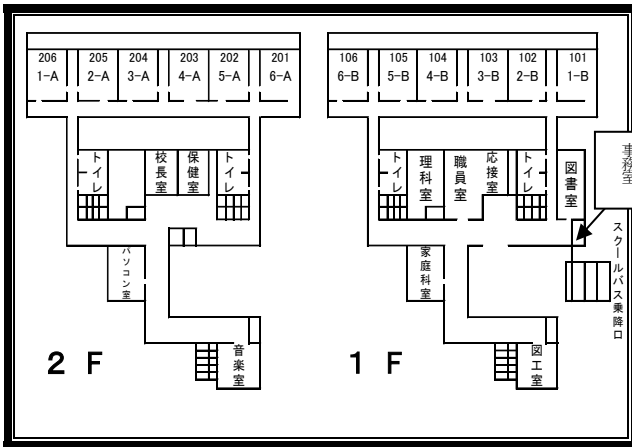

- \* When you visit, please be sure to write your name in the reception notebook.
- \* When going to the classroom, please inform a member of the school staff of your purpose. If you have any lost items, please hand them to the school staff.
- \* The back door entrance is reserved for school staff only.
- \* Vehicles are prohibited from entering the school bus rotary area.

◆ **2026 Daily Schedule**

Arrival at School / Morning Reading / Short Homeroom	8 : 25 ~ 8 : 40	School Lunch / Lunch Break	12 : 10 ~ 12 : 50
Bible Reading / 1st Period	8 : 40 ~ 9 : 25	5th Period	12 : 55 ~ 13 : 40
2nd Period	9 : 30 ~ 10 : 15	6th Period	13 : 45 ~ 14 : 30
Morning Recess	10 : 15 ~ 10 : 30	7th Period	14 : 35 ~ 15 : 20
3rd Period	10 : 35 ~ 11 : 20	Cleaning Time / Short Homeroom / Dismissal	15 : 20 ~ 15 : 35
4th Period	11 : 25 ~ 12 : 10	School Bus Departure	15 : 45

◆ **Start of Classes on Thursday the 9th**

The class schedule has been distributed in each class. Please follow your homeroom teacher's instructions regarding what to bring, and make sure not to forget anything.

For students in Grade 2 and above, please ensure they bring a lesson bag (to be hung on a desk hook and used when moving between classrooms; it should contain labeled subject folders and a red-and-white cap), as well as a blue desk drawer case.

In addition, please fill out the new family information form and health survey distributed on the closing ceremony day and submit them to your child's homeroom teacher.

Starting today, school lunches have resumed. (It will begin tomorrow for first-grade students.) Some students sometimes forget their lunch sets, so please make sure they bring them daily.

◆ **School Term Calendar and April Schedule**

The finalized annual event calendar was distributed today. The academic year is divided into three terms:

- **First Term:** Wednesday, April 8 to Saturday, July 18
- **Second Term:** Tuesday, September 1 to Saturday, December 19
- **Third Term:** Thursday, January 7 to Friday, March 12 (Saturday, March 13 for 6th graders).

Please note that there will be Saturday school days and half-day sessions. Any changes will be announced through the school newsletter "Akatsuki" or Mimamorume.

Additional details regarding the parent-teacher meeting and class observation scheduled for Wednesday,

April 29, as well as the school field trip on Thursday, April 30, will be shared at a later date.

### ◆ **Schedule of Certification Tests**

Students are encouraged to take the English Proficiency Test and Kanji Proficiency Test at least once per school year. Other certification tests are available to all students, regardless of their grade or year. These tests will be conducted during regular class periods. Students who are not participating will continue with their usual lessons. Application letters will be distributed later, so please ensure the completed forms are submitted to your homeroom teacher by the deadline.

Eiken English Test	Friday, May 22	Friday, September 25	Friday, January 22
Kanji Certification Test	Friday, July 10	Friday, February 5	
Math Certification Test	Friday, February 12		
Japanese Certification Test	Friday, June 12		

The French proficiency test is scheduled on November 15 (Sunday), please be aware that the school can hold it upon reaching the required number of applicants. A notice letter with details of application period will be distributed later.

### ◆ **About the Simultaneous Email Distribution Service and the Notice of Absence and Tardy Report Services**

This year, we will continue using Mimamorume to send school-wide emails. Information about events may also be shared through Mimamorume. We appreciate your understanding and cooperation in our efforts to reduce paper usage.

In addition, you can report absences or late arrivals through Mimamorume (by 9:00 a.m. on the day). After 9:00 a.m., please contact the elementary school directly by phone: 0438-52-3851. Please be sure to notify us if your child will be absent or late, as we will be concerned if we do not receive a message. ID cards and instructions were handed out to new students today. Please be sure to complete the registration.

### ◆ **School Forms**

You can download various forms—including absence notifications, requests for late arrival or early dismissal, and commuting method changes—from the school website. Please make use of them.

### ◆ **Notification of Kids Mobile Phone**

Please submit a notification of your child's Kid's Phone possession to the school via their homeroom teacher. Students in grade 2 and above must renew this notification every April. Ensure that the school's phone number (0438-52-3851) is included and registered in the contact list. Additionally, inform the school through the homeroom teacher whenever there is a change to your child's phone model or number. Please note that bringing smartphones to school is strictly prohibited.

### ◆ **Way of Going Home**

When leaving school, we will be checking your child's boarding of the school bus. Please inform the school or homeroom teacher promptly if there is a change in your child's method of leaving school.

For those using the Highway Line school bus (Kawasaki, Yokohama, Shinagawa, Urayasu, Chiba), it is also necessary to notify the driver in case of any changes, including absences. However, there is no need to contact the Kisarazu Line school bus.

A list of contact information for Highway Line school bus drivers was distributed today.

### ◆ **About Mimamorume GPS**

We have provided Mimamorume GPS subscription information to all new students. While subscribing is optional, we strongly encourage you to consider it for enhanced safety and security for your children. Current students who wish to subscribe may contact our office for assistance.

### ◆ **Textbooks**

Textbooks have been distributed today. Kindly note that textbooks approved by the Ministry of Education are provided free of charge. However, payment for purchased textbooks, such as foreign-language books, will be withdrawn soon. Please ensure that the required amount has been deposited into the children's allowance account.

### ◆ **Maria Boutique**

Please take note of the following points when purchasing uniforms or school supplies from the boutique:

- Business hours are from 8:20 a.m. to 4:30 p.m. Due to schedule changes, the boutique will be closed on Saturdays. (It will be open on Saturdays when school events are held.)
- When filling out the order slip, be sure to include the item name, size, and quantity. Additionally, indicate preferences such as male/female, short sleeves, long sleeves, etc.
- Parents may purchase items directly from the boutique using cash only. Please note that credit cards and electronic payments are not accepted.
- If you wish to exchange items for a different size, please do so within one week of purchase. Ensure that the items are returned in their original condition with tags, bags, boxes, etc. intact. Please note that certain items may not be eligible for exchange depending on the circumstances.

If you have any questions, please feel free to contact Maria Boutique:

TEL: 0438-52-2510 FAX: 0438-52-3846 E-mail: [boutique@gis.ac.jp](mailto:boutique@gis.ac.jp)

### ◆ **Separate Payment of Tuition from Deposit into Student Account**

Please ensure that bank transfer payments for tuition are kept separate from deposits into the student account. We are unable to transfer funds from one account to another. Furthermore, when making a bank transfer, please enter the six-digit student ID number and the student's name.

**Tuition Payment Details:**

**Amount:** 3072188 **Account Type:** Savings **Bank:** Chiba Bank **Branch:** Kisarazu

**Student Account Deposit Details:**

**Option 1: Account Number:** 1100029 **Account Type:** Savings **Bank:** Chiba Bank **Branch:** Kisarazu

**Option 2: Account Number:** 0279121 **Account Type:** Savings **Bank:** Mitsubishi UFJ Bank **Branch:** Kisarazu

### ◆ **Requests received in school evaluation questionnaires**

We have reviewed the requests received through the school evaluation survey and have made several improvements. We will continue to implement further changes wherever possible.

### ◆ **School Counseling Information**

School counselor, [REDACTED] visits the school every Thursday morning. He is available to meet with students and parents/guardians to address their concerns and provide guidance in finding solutions. To schedule a meeting with Mr. Ohtake, please contact your child's homeroom teacher.

### ◆ **National Spring Traffic Safety Campaign**

The National Spring Traffic Safety Campaign is being held from Monday, April 6 to Wednesday, April 15. Please be aware of the changes to traffic safety rules from April. The school will provide traffic safety instruction, and we appreciate your support in reinforcing traffic safety at home.